

APPROVED 5/8/19

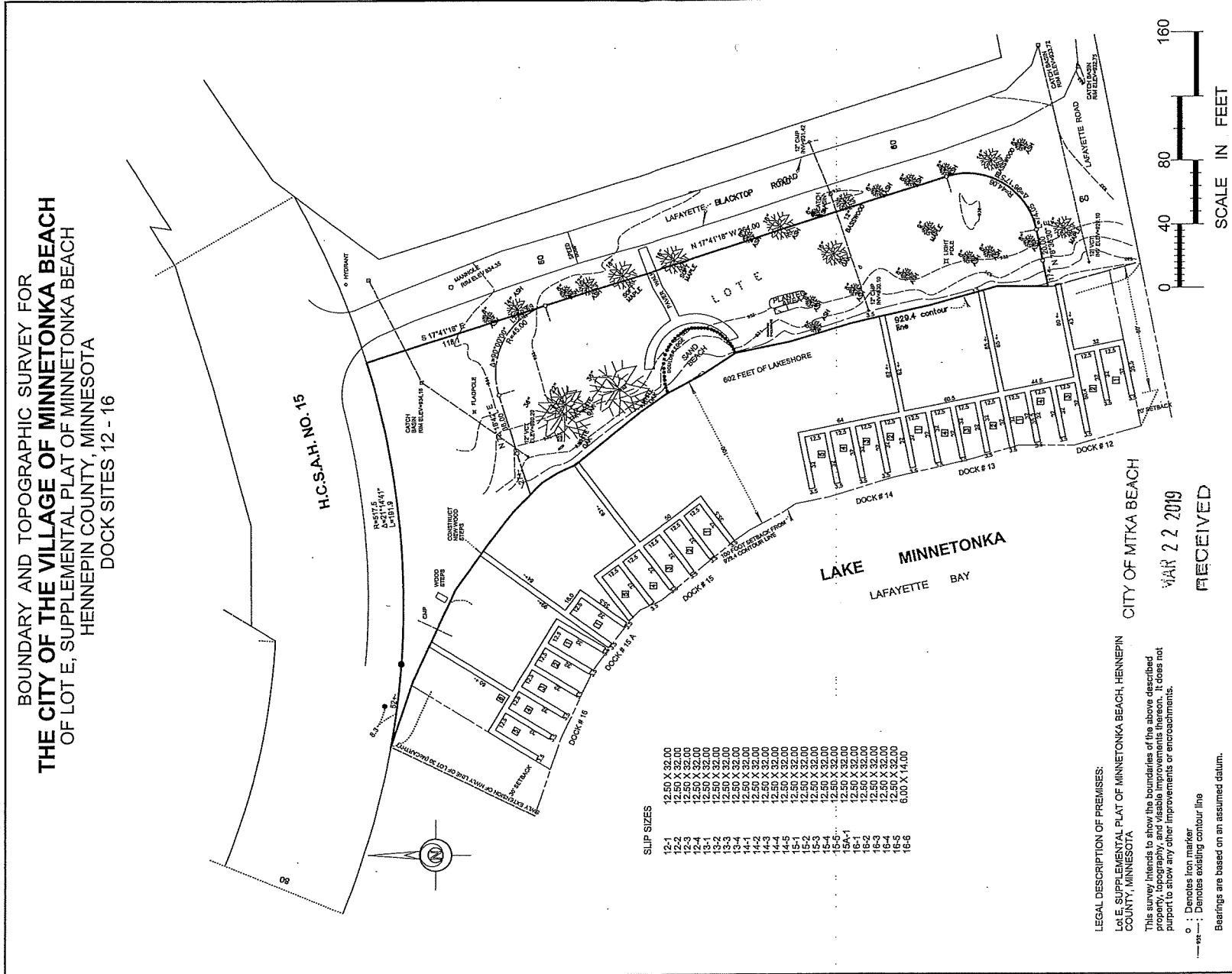

H.C.S.A.H.N.O.N.15

SLIP SIZES

12-1	12.50 X 32.00
12-2	12.50 X 32.00
12-3	12.50 X 32.00
13-1	12.50 X 32.00
13-2	12.50 X 32.00
13-3	12.50 X 32.00
13-4	12.50 X 32.00
14-1	12.50 X 32.00
14-2	12.50 X 32.00
14-3	12.50 X 32.00
14-4	12.50 X 32.00
14-5	12.50 X 32.00
15-1	12.50 X 32.00
15-2	12.50 X 32.00
15-3	12.50 X 32.00
15-4	12.50 X 32.00
15-5	12.50 X 32.00
15-6	12.50 X 32.00
15A-1	12.50 X 32.00
16-1	12.50 X 32.00
16-2	12.50 X 32.00
16-3	12.50 X 32.00
16-4	12.50 X 32.00
16-5	12.50 X 32.00
16-6	6.00 X 14.00

LEGAL DESCRIPTION OF PREMISES:
 Lot E, SUPPLEMENTAL PLAT OF MINNETONKA BEACH, HENNEPIN COUNTY, MINNESOTA

This survey intends to show the boundaries of the above described property, topography, and visible improvements thereon. It does not purport to show any other improvements or encroachments.

o : Denotes iron marker
 ---o--- : Denotes existing contour line
 Bearings are based on an assumed datum.

WAR 22 2019
 RECEIVED

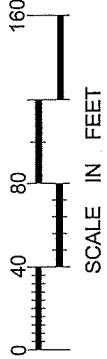

DESIGNED	REVISION	DATE	DESCRIPTION
	1	3-22-19	REVISIONS TO DOCK 15A AND 16
DRAWN			
CHECKED			

I HEREBY CERTIFY THAT THIS PLAN, SPECIFICATION, OR REPORT WAS PREPARED BY ME OR UNDER MY DIRECT SUPERVISION AND THAT I AM A DULY LICENSED PROFESSIONAL ENGINEER AND LAND SURVEYOR UNDER THE LAWS OF THE STATE OF MINNESOTA. <i>Michael J. Gronberg</i> DATE: 3-22-19 MIN LICENSE NUMBER: 122333	
SCALE	1"=40'
DATE	12-2-09
JOB NO.	19-063

GRONBERG & ASSOCIATES, INC.
 CONSULTING ENGINEERS, LAND SURVEYORS
 SITE PLANNERS
 445 N. WILLOW DR. LONG LAKE, MN. 55356
 952-479-4141

